

## DATA SHEET - LAYDOWN CONCRETE SKIP WITH SIDE DISCHARGE AND LEVERED OPENING

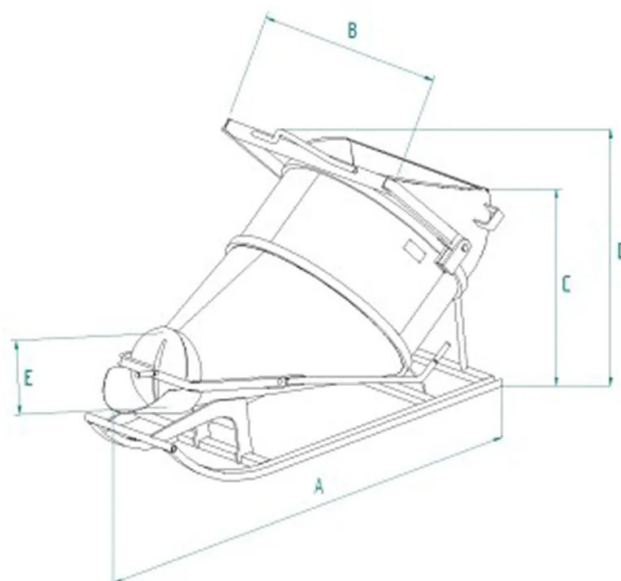

Code	Capacity (kg)	Capacity (L)	Weight (kg)	Dimensions (mm)				
				A	B	C	D	E
BF-30CL	780	300	130	1480	1020	765	1002	300
BF-40CL	1040	400	140	1605	1020	872	1110	300
BF-50CL	1300	500	150	1728	1020	975	1212	300
BF-75CL	1950	750	295	2135	1350	1045	1540	420
BF-99CL	2600	1000	310	2272	1350	1137	1675	420
BF-150CL	3900	1500	590	2490	1692	1228	1845	420
BF-200CL	5200	2000	640	2775	1692	1376	1707	420

## DATA SHEET - LAYDOWN CONCRETE SKIP WITH SIDE DISCHARGE AND LEVERED OPENING

Concrete buckets



### Laydown concrete skip with side discharge and levered opening

#### Laydown concrete bucket with side discharge and lever opening

The laydown concrete bucket is specially designed to facilitate ground loading via the concrete mixer, thanks to its reduced edge height. This model, with its distinctive and innovative construction, features a side discharge once lifted and positioned vertically by the crane, making it ready for use. The valve is equipped with a guillotine closure operated by two side levers, ensuring precise control over the concrete pour. All our buckets are built and tested in compliance with stringent standards UNI EN ISO 12100, UNI EN 13854, ISO 8686, UNI EN 10027, and UNI EN 10204. Each product comes with a metal ID plate, a certificate of conformity, and an operation and maintenance manual to ensure correct long-term use. Furthermore, all our products are covered by a one-year warranty in accordance with European Directive, and are made with certified materials to ensure durability and safety, meeting the required quality standards in the construction sector.

#### Application sectors

 Construction