

DATA SHEET - LAYDOWN CONCRETE SKIP WITH SIDE DISCHARGE AND GEARED OPENING

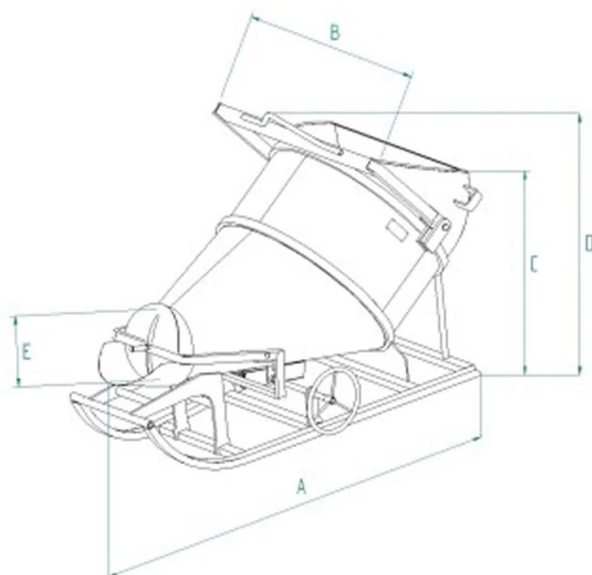

Code	Capacity (kg)	Capacity (L)	Weight (kg)	Dimensions (mm)				
				A	B	C	D	E
BF-30CV	780	300	150	1507	1020	915	1030	300
BF-50CV	1300	500	170	1752	1020	1125	1457	300
BF-75CV	1950	750	340	2166	1350	1131	1443	420
BF-99CV	2600	1000	355	2305	1350	1227	1588	420
BF-150CV	3900	1500	615	2490	1692	1230	1560	420
BF-200CV	5200	2000	765	2775	1692	1376	1707	420

DATA SHEET - LAYDOWN CONCRETE SKIP WITH SIDE DISCHARGE AND GEARED OPENING

Concrete buckets



Laydown concrete skip with side discharge and geared opening

Laydown concrete bucket with side discharge and double wheel opening

The laydown concrete bucket is specially designed to facilitate ground loading via the concrete mixer, thanks to its reduced edge height. This model, with its distinctive and innovative construction, features a side discharge once lifted and positioned vertically by the crane, making it ready for use. The bucket's valve is equipped with a guillotine closure operated by two side handwheels and a spring that facilitates closure, ensuring precise control over the concrete pour. All our buckets are built and tested in compliance with stringent standards UNI EN ISO 12100, UNI EN 13854, ISO 8686, UNI EN 10027, and UNI EN 10204. Each product comes with a metal ID plate, a certificate of conformity, and an operation and maintenance manual to ensure correct long-term use. Furthermore, all our products are covered by a one-year warranty in accordance with the European Directive, and are made with certified materials to ensure durability and safety, meeting the required quality standards in the construction sector.

Application sectors

 Construction